

15 SPARE PARTS LIST 13.6516.01

13.6516.01	A380/19/0.70-0.80/7.5		A380.0004.01		15.07.99	
Item-No.		in group	Pcs.	Description	Dimension	Field
A3H.1110			1	FILTER NETTING		B9
A3H.1111			1	NETTING FRAME		B9
A3H.1112			1	PROTECTION NETTING		B9
A3H.1709			1	ADJUSTING SCREW		D6
[A38.0103]			1	TENSIONING UNIT	1/2"-20.0/7,5KN	A22
[A38.0107]			1	VALVE HANDLE		C15
[A38.0109]			1	CONTROL VALVE		A17
[A38.0117]		A38.0103	1	AIR MOTOR	EXC. 2,5	B22
[A38.0131]		A38.0117	1	MOTOR CELL	EXC. 2,5	B21
A38.1108	*		1	DIE HALF		D3
A38.1109	*		1	DIE HALF		D4
A38.1110	*		1	CUTTER		C4
A38.1111			1	GUIDE KEY		B3
[A38.1112]			1	SPRING PACKAGE		B6
A38.1113		A38.1112	1	SPINDLE		B5
A38.1114		A38.1112	1	BUSH		B5
A38.1116			1	BASE PLATE		C6
A38.1119	*		1	PUNCH		C5
A38.1120			1	STRAP CLAMP		B4
A38.1124			1	STRAP STOP		C6
A38.1126			1	FLAPPER		C2
A38.1130			1	STRAP GUIDE		C2
A38.1135			1	STRAP GUIDE		B1
A38.1137			1	FLAP PIVOT PIN		B3
A38.1138			1	SOCKET SET SCREW		A3
A38.1140			1	PISTON ROD		C9
A38.1141			1	HINGE		C9
A38.1142			1	BOLT		C9
A38.1143			1	BOLT		B1
A38.1144			1	HINGE PLATE		B1
A38.1145			1	CYLINDER COVER		A9
A38.1146			1	PISTON ROD		C7
A38.1147			1	FORK		C23
A38.1148			1	SHAFT		C23
A38.1149			1	COVER		B7
A38.1150			1	GUIDE RING		C8
A38.1151			1	COVER DISK		C8
A38.1152			2	BLIND PLUG		B9+
A38.1155			1	PLUNGER		C11
A38.1156			1	DISK		B11
[A38.1176]			1	SEALING HOUSING		A4
A38.1186		A38.1189	1	EJECTOR SPINDLE		C3
A38.1187		A38.1189	1	EJECTING BUSH		C3
[A38.1189]			1	EJECTOR		C4
A38.1190		A38.1189	1	CAP		C3
A38.1191			1	DIE AND CUTTER SUPPORT		B4
A38.1202		A38.0107	1	SECURITY VALVE SHELL		D14
A38.1203		A38.0107	1	VALVE BOLT		D13
A38.1204		A38.0107	1	SHAFT		D13
A38.1205		A38.0107	1	SECURITY LEVER		D14
A38.1206		A38.0107	1	LEVER BODY		D13

* = Wearing parts

[] = Group

13.6516.01	A380/19/0.70-0.80/7.5		A380.0004.01		15.07.99	
Item-No.		in group	Pcs.	Description	Dimension	Field
A38.1208		A38.0107	1	SEALER VALVE SHELL		B14
A38.1209		A38.0107	4	VALVE BOLT		A14
A38.1210		A38.0107	1	TENSIONER VALVE LEVER		A15
A38.1211		A38.0107	1	SEALING VALVE LEVER		B15
A38.1212		A38.0107	1	SHAFT		A14
A38.1213		A38.0107	1	LEVER BODY		A14
A38.1214		A38.0107	1	CATCH PIN		B15
A38.1215		A38.0107	1	GUIDE RING		C16
A38.1216		A38.0107	5	SUSTAINING RING		B17+
A38.1216		A38.0109	4	SUSTAINING RING		B18
A38.1216			5	SUSTAINING RING		C9
A38.1217		A38.0107	1	GUIDE RING		C17
A38.1218		A38.0107	1	VALVE PISTON		C17
A38.1220		A38.0107	1	VALVE LEVER		D17
A38.1221		A38.0107	1	SHAFT		D17
A38.1222		A38.0107	1	LEVER BODY		D17
A38.1226		A38.0109	1	CYLINDER CAP		C18
A38.1227		A38.0109	1	CYLINDER RING		C18
A38.1228		A38.0109	1	PISTON BAR		C18
A38.1229		A38.0109	1	THRUST PIECE		A18
A38.1231			1	SEAL PLATE		B17
[A38.1236]			1	MOTOR TUBE		A16
[A38.1237]			1	CYLINDER HOSE		C12
A38.1238		A38.0107	1	GUARD-PLATE		D14
[A38.1241]		A38.0107	1	VALVE HOUSING		C15
A38.1242		A38.0107	1	TENSIONER VALVE SHELL		B15
A38.1243			1	SEAL PLATE		C14
[A38.1244]		A38.0109	1	CONTROL VALVE BODY		A17
[A38.1246]			1	VALVE HEAD		D10
A38.1248			1	SEALING STRIP		D10
A38.1249			1	VALVE STEM		D10
A38.1250			1	DISTANCE SLEEVE		D9
A38.1251			1	COMPENSATOR RING		C10
A38.1253		A38.0107	1	THROTTLE SCREW		C14
A38.1272			1	JOINT CONE		B16
A38.1274		A38.1244	1	HOLDING AIR THROTTLE		A17
A38.1275		A38.0107	1	SLIDE BOLT		C16
A38.1276		A38.0107	1	RING		B15
A38.1277		A38.0107	1	SCREW		A15
A38.1278		A38.0107	1	EJECTION HEAD		A15
A38.1279		A38.0107	1	EJECTING BOLT		A15
A38.1280		A38.0109	1	SEALING SCREW		A18
A38.1281		A38.0109	1	TOUCH BOLT		A18
A38.1282		A38.0107	1	LEVER		A16
A38.1283		A38.0107	1	SHAFT		A16
A38.1310			1	TENSIONING BODY		C22
[A38.1311]	*		1	GRIPPER		C22
A38.1314			1	PIVOT PIN		C21
A38.1315			1	BOLT		D21
A38.1316			1	SPACER RING		C21
A38.1319	*		1	TENSIONING WHEEL		D21
A38.1320			1	SPACER RING		D21
A38.1324			1	STRAP HOLDER		D21

* = Wearing parts

[] = Group

13.6516.01	A380/19/0.70-0.80/7.5		A380.0004.01		15.07.99	
Item-No.		in group	Pcs.	Description	Dimension	Field
A38.1326			1	END COVER		D21
A38.1330			1	STRAP STOP		C21
A38.1333			1	RETAINER		D22
A38.1349		A38.0131	1	END PLATE		C20
A38.1350		A38.0131	1	JACKET		B21
A38.1351	*	A38.0131	8	VANE		C20
A38.1352		A38.0131	1	END PLATE		B21
[A38.1353]		A38.0117	1	AIR MOTOR HOUSING		B21
A38.1354		A38.0117	1	COVER		A20
[A38.1355]		A38.0103	1	HOUSING		C22
A38.1360		A38.0103	1	PINION		A23
A38.1363		A38.0103	1	INTERMEDIATE WHEEL	2-3	B23
A38.1365		A38.0103	1	INTERMEDIATE WHEEL	1-2	A22
A38.1368		A38.0103	1	TENSION SHAFT		C23
A38.1370		A38.0103	1	BEARING PLATE		C24
A38.1371		A38.0103	1	INTERMEDIATE WHEEL		B23
[A38.1372]		A38.0103	1	BODY COVER		B24
A38.1374		A38.0131	16	FELT		B20+
A38.1376		A38.0131	1	ROTOR		C20
A38.1377		A38.0131	1	COUPLING		B20
A38.1378		A38.0131	1	DOWEL		B20
[A38.1431]			1	SUSPENSION		--
[A38.1432]		A38.1431	1	SUSPENSION BRACKET		--
A38.1501			1	SEALING CYLINDER		B8
A38.1502		A38.1511	1	PISTON PLATE		B11
A38.1503		A38.1512	1	CYLINDER COVER		A12
A38.1506		A38.1512	1	PRESSION SETTING SCREW		A10
A38.1507		A38.1512	1	VARIABLE PISTON		A11
A38.1508		A38.1512	1	BALL SEAT		A12
A38.1509		A38.1512	1	CONNECTING SCREW		B12
A38.1510		A38.1512	1	SEALING PLUG		A10
[A38.1511]			1	PISTON PLATE		B11
[A38.1512]			1	CYLINDER COVER		A12
A38.1513			1	CLAMPING PIECE		C4
[A38.2155]			1	PISTON PLATE		C9
A38.2156			1	STOP DISK		C9
A38.2157			1	SUPPORTING DISK		B10
A38.2158			1	HEXACON NUT		B9
A48.1234		A38.0107	1	CATCH		B15
A48.1237		A38.0107	1	SIEVE		C13
N1.1104		A38.1431	2	SCREW	M8 X 20	--
N1.1106			5	SCREW	M6 X 20	A8+
N1.1113		A38.0103	4	SCREW	M5 X 20	A24
N1.1114			4	SCREW	M5 X 25	C24+
N1.1125			4	SCREW	M6 X 16	B8
N1.1130		A38.0103	4	SCREW	M5 X 35	B24
N1.1133			2	SCREW	M5 X 40	D10
N1.1141			1	SCREW	M6 X 40	D15
N1.1143			4	SCREW	M6 X 35	A17+
N1.1168			1	SCREW	M5 X 16	A10
N1.1174			3	SCREW	M10 X 1 X 40	D5
N1.1175			2	SCREW	M5 X 55	A10
N1.1180		A38.0117	4	SCREW	M6 X 90	B19

* = Wearing parts

[] = Group

13.6516.01	A380/19/0.70-0.80/7.5		A380.0004.01			15.07.99
Item-No.		in group	Pcs.	Description	Dimension	Field
N1.1181			1	SCREW	M5 X 12	C4
N1.1304			2	SCREW	M3 X 8	D5
N1.1560		A38.0107	2	HEXAGON SCREW	M5 X 10	D14
N1.1560			7	HEXAGON SCREW	M5 X 10	B1+
N1.1806			4	SCREW	M4 X 10	D4
N1.1807			3	SCREW	M5 X 12	C21+
N1.2101			1	COUNTERSUNK SCREW	M8 X 25	B11
N1.2102			4	COUNTERSUNK SCREW	M6 X 20	A10
N1.2106			2	COUNTERSUNK SCREW	M4 X 8	C9
N1.2212		A38.0107	7	COUNTERSUNK SCREW	M4 X 25	A14+
N1.2212			1	COUNTERSUNK SCREW	M4 X 25	B3
N1.5608			1	SLOTTED ROUND NUT	M8 X 1	B7
N1.6203			2	SPRING LOCK WASHER	M3	C5
N1.6207		A38.0103	8	SPRING LOCK WASHER	M5	A24+
N1.6207			9	SPRING LOCK WASHER	M5	A10+
N1.6220		A38.0117	4	SPRING LOCK WASHER	M6	A20
N1.6220			14	SPRING LOCK WASHER	M6	B8+
N1.6310		A38.0103	2	SPACER WASHER	14 X 26 X 0,5	B23+
N1.6501		A38.1431	2	SAFETY WASHER	M8	--
N1.6502			3	SAFETY WASHER	M10	D6
N2.1125		A38.0107	2	SECURITY RING	E3.2	A15+
N2.1125			2	SECURITY RING	E3.2	C22
N2.1215		A38.0107	1	SECURITY RING	J22	B15
N2.1301		A38.1112	1	CIRCLIP	6 MM	A6
N2.1701			1	SECURITY RING	17 MM	C7
N2.1702			1	SECURITY RING	26 MM	D9
N2.2101			1	PARALLEL PIN	5 M6 X 12	B1
N2.2107			2	PARALLEL PIN	5 M6 X 40	D21
N2.2109			2	PARALLEL PIN	8 M6 X 30	B6
N2.2112			1	PARALLEL PIN	3 M6 X 12	C5
N2.2114		A38.0107	1	PARALLEL PIN	4 M6 X 24	C14
N2.2138			3	PARALLEL PIN	4 M6 X 12	D4+
N2.2143		A38.0103	2	PARALLEL PIN	5 H6 X 16	A23
N2.2144		A38.0103	1	PARALLEL PIN	14 H6 X 75	C23
N2.2413		A38.0131	1	DOWEL PIN	4 X 20 MM	B21
N2.2440			1	DOWEL PIN	4 X 12 MM	B4
N2.2441			2	DOWEL PIN	6 X 20 MM	C23
N2.2445		A38.0131	1	DOWEL PIN	2,5 X 6 MM	C20
N2.2449			2	DOWEL PIN	3,5 X 20 MM	C24
N2.4407		A38.0103	4	RIVET	2 X 3	A23+
N2.4902			4	HAMMER HEAD BOLT	1,85 X 4,76	B9
N2.5102		A38.0107	1	PRESSURE SPRING	0.6 X 8 X 14/6	D14
N2.5102		A38.0109	1	PRESSURE SPRING	0.6 X 8 X 14/6	A18
N2.5151		A38.0107	1	PRESSURE SPRING	0.3 X 2.8 X 11	C15
N2.5159		A38.0107	2	PRESSURE SPRING	0.5 X 7 X 18	B14
N2.5160		A38.0107	1	PRESSURE SPRING	1 X 12 X 26	C16
N2.5161		A38.0107	2	PRESSURE SPRING	1 X 12 X 20	B14
N2.5161		A38.1512	1	PRESSURE SPRING	1 X 12 X 20	B12
N2.5162			1	PRESSURE SPRING	2 X 42 X 22	C8
N2.5163			1	PRESSURE SPRING	5.5 X 74 X 155	A8
N2.5168			1	PRESSURE SPRING	0.5 X 10 X 22	B16
N2.5601		A38.1112	52	CUP SPRING	12.5X6.2X0.7	B5
N2.5609		A38.0117	2	CUP SPRING	45X22.5X1.75	A20

* = Wearing parts

[] = Group

13.6516.01	A380/19/0.70-0.80/7.5		A380.0004.01			15.07.99
Item-No.		in group	Pcs.	Description	Dimension	Field
N2.5610		A38.1189	60	CUP SPRING	8X3.2X0.5	C3
N2.5612		A38.1512	9	CUP SPRING	20X10.2X0.5	A11
N2.5616			2	CUP SPRING	50 X 25.4 X 2.5	C10
N2.5805			1	BENDING SPRING		A4
N3.1109		A38.1355	1	BALL BEARING		B22
N3.1109		A38.1372	1	BALL BEARING		A23
N3.1123		A38.0131	1	BALL BEARING		B21
N3.1133		A38.0131	1	BALL BEARING		C19
N3.1703		A38.0103	1	BALL	5 MM.	C24
N3.1706		A38.0107	2	BALL	15 MM	B14
N3.1706		A38.1512	1	BALL	15 MM	B12
N3.1708		A38.0107	1	BALL	10 MM	D14
N3.2319			1	NEEDLE CASE		D21
N3.2322		A38.1355	1	NEEDLE CASE		B22
N3.2322		A38.1372	1	NEEDLE CASE		A23
N3.2323		A38.1355	1	NEEDLE CASE		B22
N3.2323		A38.1372	1	NEEDLE CASE		B24
N3.2602			1	PACKING RING		D21
N3.2603		A38.0103	1	PACKING RING		C22
N3.3119			1	SLIDE-BEARING		B2
N3.3124			1	SLIDE-BEARING		B2
N3.3128		A38.0103	1	HEADED PRESS FIT BUSH		C23
N3.3129		A38.0103	2	SLIDE-BEARING		B23+
N3.3130		A38.0103	1	HEADED PRESS FIT BUSH		C24
N41.9128			1	ADHESIVE LABEL		A11
N41.9129			1	ADHESIVE LABEL		A11
N4.5110		A38.0107	1	CAP		B15
N4.5110			1	CAP		A15
N4.9131			1	LABEL	<<A380>>	B9
N4.9159			1	LABEL	<<CE>>	B8
[N6.3404]			1	PISTON		B7
N6.3501		A38.1511	1	INNER PACKING	12.31X24.1X6.5	B11
N6.3504		N6.3404	1	INNER PACKING	8.3X12.1X4	B7
N6.3507		A38.2155	1	EXTERNAL PACKING RING		B10
N6.3508		N6.3404	1	EXTERNAL PACKING RING		B7
N6.5133		A38.0107	1	REDUCING COUPLING		C13
N6.5138		A38.1512	1	SEALING SCREW		A11
N6.5508		A38.0117	1	EXHAUST SILENCER	R 1/2"	A22
N6.5624		A38.0107	1	ANGLE		C13
N6.5627			1	HOLLOW SCREW		B17
N6.5628			2	HOLLOW SCREW		C12+
N6.5634			2	PACKING RING		B17
N6.5635			4	PACKING RING		C12+
N6.5637		A38.0117	1	ADAPTER		A21
N6.6107			1	SEAL	56 X 46 X 10	B4
N6.6108			1	SEAL	16 X 24 X 5	D8
N6.6113			1	PACKING RING	10 X 16 X 4.5	C7
N6.6114		A38.0109	1	LIP SEAL	12 X 6 X 4	C18
N6.6115		A38.0109	1	LIP SEAL	16 X 10 X 4	C18
N6.6116			1	SEAL	18 X 28 X 17.5	C8
N6.6117		A38.0107	5	SEAL	6 X 13 X 2.3	B16+
N6.6117		A38.0109	4	SEAL	6 X 13 X 2.3	A18+
N6.6117			5	SEAL	6 X 13 X 2.3	C10+

* = Wearing parts

[] = Group

13.6516.01	A380/19/0.70-0.80/7.5		A380.0004.01			15.07.99
Item-No.		in group	Pcs.	Description	Dimension	Field
N6.6120			1	SEAL	16 X 9 X 2.3	D10
N6.6124		A38.1512	1	PACKING RING	25 X 18 X 2.3	A11
N6.6145			1	DIAPHRAGM		C14
N6.6204		A38.0107	4	O-RING	18 X 2	B14
N6.6207		A38.1244	1	O-RING	3,1 X 1,6	A17
N6.6217		A38.0107	8	O-RING	15 X 2	B16+
N6.6217		A38.0109	6	O-RING	15 X 2	A18+
N6.6217			6	O-RING	15 X 2	C10+
N6.6223		A38.0117	1	O-RING	50 X 2	B21
N6.6229		A38.0103	1	O-RING	14 X 1	B24
N6.6230		A38.0107	1	O-RING	8 X 1,5	D14
N6.6233		A38.0107	1	O-RING	6 X 2	B15
N6.6235		A38.0107	2	O-RING	12 X 2	B15
N6.6237			1	O-RING	33 X 1,5	B7
N6.6238			1	O-RING	60 X 2	B9
N6.6241		A38.0131	2	O-RING	46 X 2	B20+
N6.6243		A38.1512	1	O-RING	135 X 2,5	B11
N6.6244		A38.1512	1	O-RING	22 X 2	A12
N6.6247			1	O-RING	5 X 2,5	B16
N6.6251			1	O-RING	18 X 1.5	C9
N6.6252			1	O-RING	12 X 1.5	B9
N6.6309		A38.1511	1	SEAL		C11
N6.6504		A38.1512	1	FLAT SEAL	13 X 10 X 1,5	A11
N6.6803		A38.0103	1	PACKING RING	10 X 19 X 9.8	C22
N7.1104			1	BUSH		D20
N7.1202			1	SEALING DISK		D20

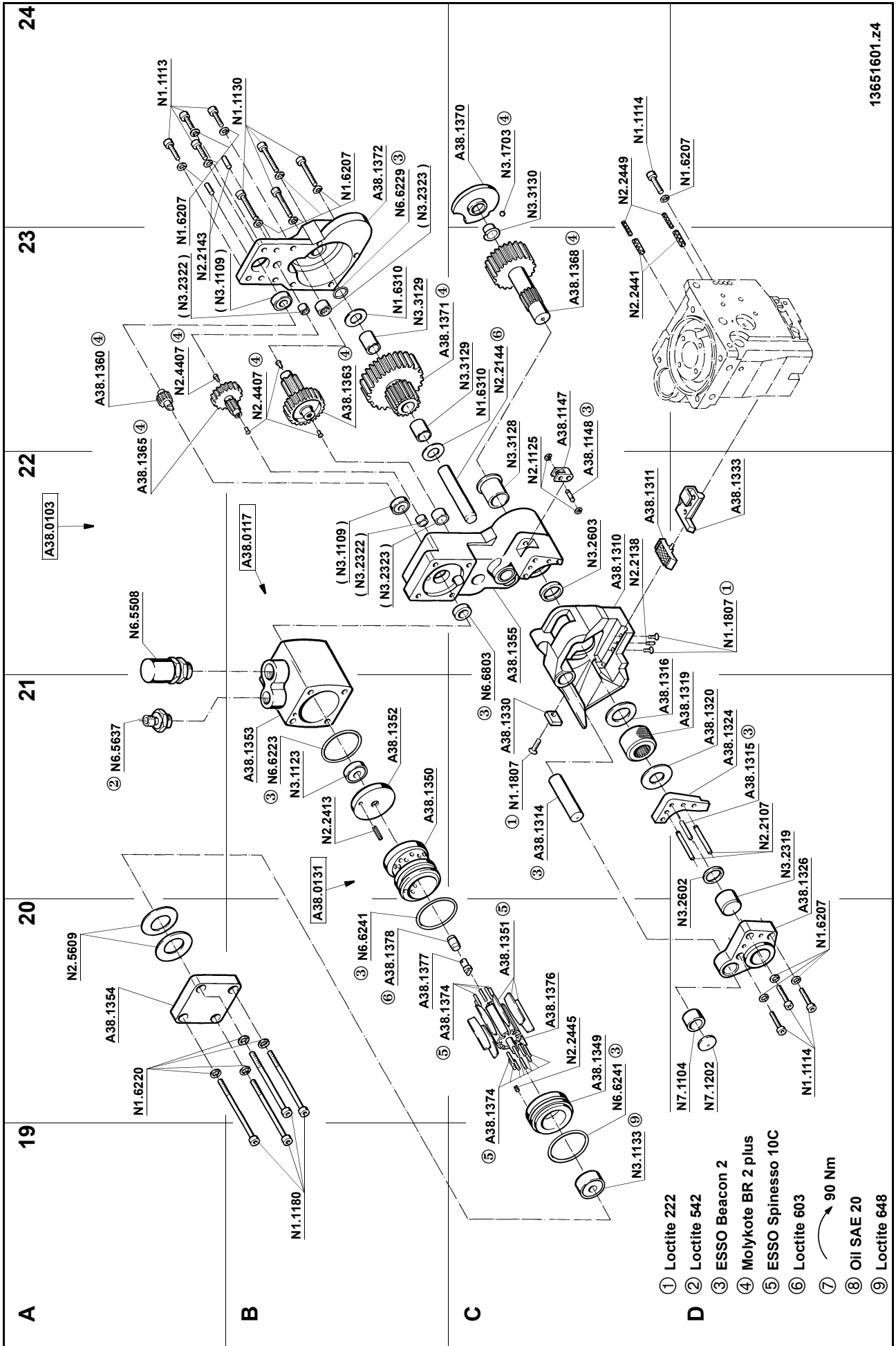

13651601.z4